

This Space for Architect/Engineer Approval

Job Name _____ Date _____

Model Specified _____ Quantity _____

Customer/Wholesaler _____

Contractor _____

Architect/Engineer _____

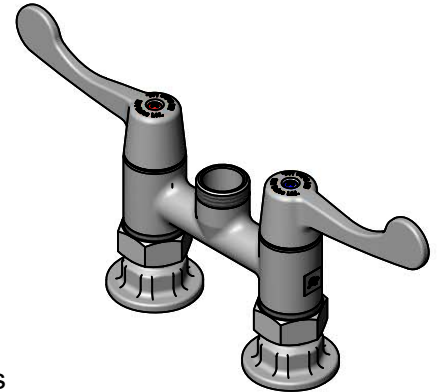
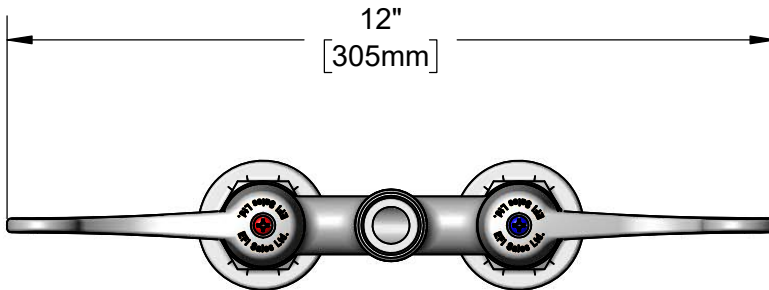

Swivel Outlet Accepts
EFI Swing Nozzles

Quarter-Turn
Ceramic Cartridges &
EFI Wrist Action Handles
w/ Color Coded Screws

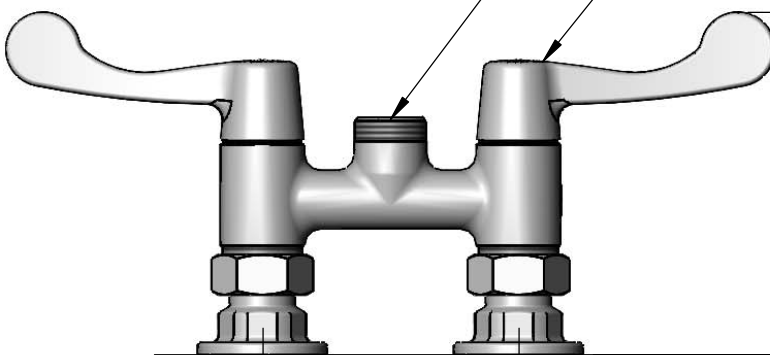

5 3/8"
[136mm]



4"
[102mm]

Adjustable from
3 3/4" to 4 1/4"
[95mm to 108mm]

Ø 2" [51mm]
Flanges w/
1/2" NPT
Female Inlets

Model Number

SIF-F4DW00

Product Specifications:

4" Deck Mount Mixing Faucet, Less Nozzle, Quarter-Turn Ceramic Cartridges, EFI Wrist Action Handles, & 1/2" NPT Female Inlets

Product Compliance:

ASME A112.18.1 / CSA B125.1
NSF 61 - Section 9
NSF 372 (Low Lead Content)
ANSI A117.1 (ADA)

efi sales Ltd

26895 Gloucester Way
Langley BC V4W 3Y3
Toll Free: 1.888.565.9020
Phone: 604.607.8850
efifoodequip.com

Drawn: KJG Checked: JRM Approved: JHB Date: 09/12/22 Scale: 1:3 Sheet: 1 of 2

ITEM NO.	SALES NO.	DESCRIPTION
1	SIF-WA4	EFI Wrist Action Handle w/ Color Coded Screws
2	013788-45	Quarter-Turn Ceramic Cartridge, LTC
3	013787-45	Quarter-Turn Ceramic Cartridge, RTC

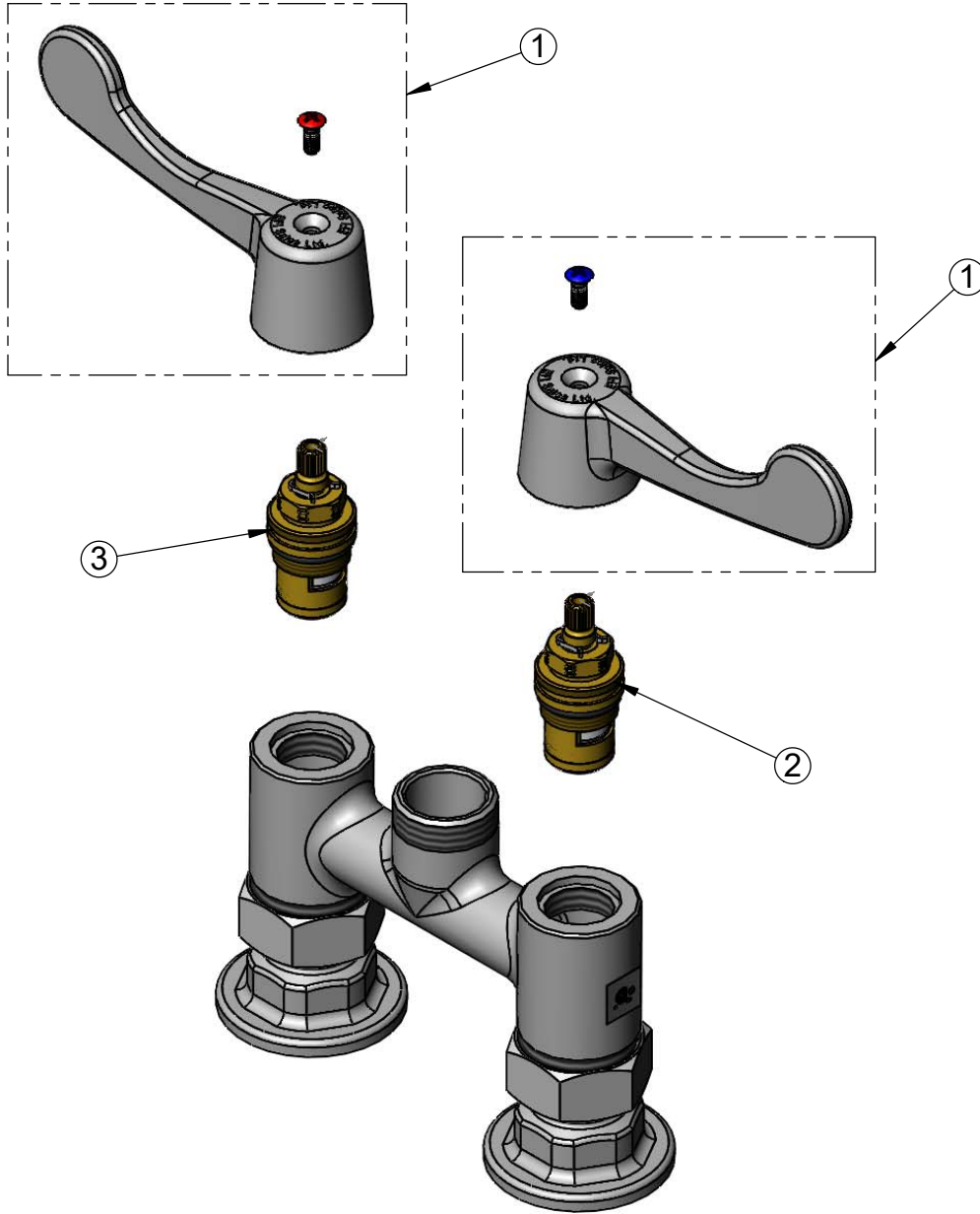

Model Number

SIF-F4DW00

Product Specifications:

4" Deck Mount Mixing Faucet, Less Nozzle, Quarter-Turn Ceramic Cartridges, EFI Wrist Action Handles, & 1/2" NPT Female Inlets

Product Compliance:

ASME A112.18.1 / CSA B125.1
NSF 61 - Section 9
NSF 372 (Low Lead Content)
ANSI A117.1 (ADA)



26895 Gloucester Way
Langley BC V4W 3Y3
Toll Free: 1.888.565.9020
Phone: 604.607.8850
efifoodequip.com